

SPARTAN ARMOR SYSTEMS® D.T. SPYDER REACTIVE DUELING TREE SHOOTING TARGET



With a few simple steps you will be able to set up and collapse your new Spartan Armor Systems® D.T. Spyder reactive dueling tree shooting target.

While setting up and collapsing the target system, please be careful to avoid finger or hand pinching hazards.

Set up and use the D.T. Spyder target system in a responsible manner and safe location.

TO SET UP TARGET

1) Starting with the front legs, doing one leg at a time, pull up on the spring-loaded pull pin that holds each leg in place on the base of the target.

2) While swinging each leg outward, let go of the spring-loaded pull pin. When each leg is fully extended and in the proper position the spring-loaded pull pin will snap into a hole in the base of the target. This will secure each leg.

3) At the base of the target spine, pull the silver cotter pin (detent pin) outward removing it completely from the target spine and the target base.

4) Fold the target spine upward into an upright position. Insert the cotter pin (detent pin) into the base hole and then the spine holes that align with the correct angle-of-lean you will need while shooting (pistol lean 6° or forward rifle lean 18°).

5) Push cotter pin (detent pin) all the way through the aligned set of holes until the spring-loaded ball in the cotter pin (detent pin) locks the pin in place.

6) At the base of the spine, pull out the safety tab with the index finger of one hand (this will release the stabilizing foot) then push down on the stabilizing foot with the other hand.

7) Push stabilizing foot all the way to the ground.

8) Fold the first section of the spine up and into place. It will quietly lock into the upright position.

9) Fold the second section of the spine up and into place. It will quietly lock into the upright position as well.

10) Add the 6 target paddles to the target spine by placing each paddle arm into the holes of a set of collar brackets. Each paddle sits into a hole in each of the collar brackets, an upper collar and a lower collar bracket for each paddle.

The target is now ready for use.

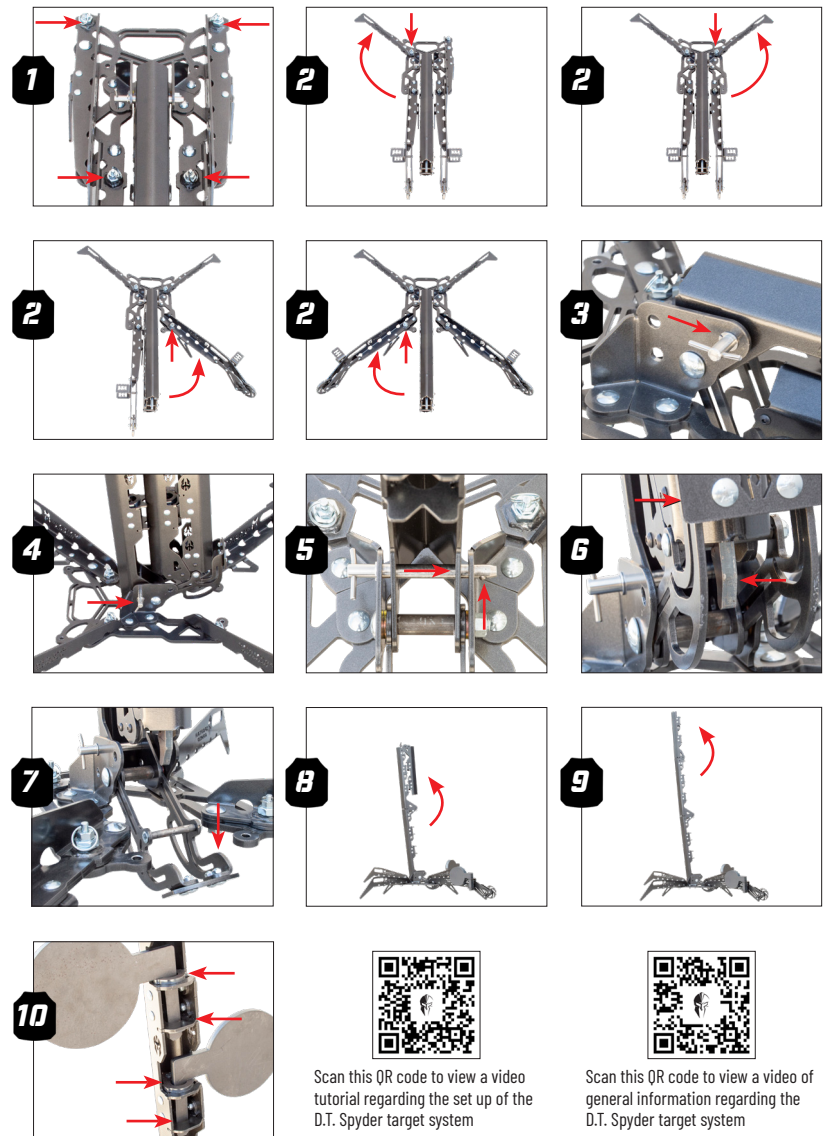

Scan this QR code to view a video tutorial regarding the set up of the D.T. Spyder target system

Scan this QR code to view a video of general information regarding the D.T. Spyder target system

SPARTAN ARMOR SYSTEMS® D.T. SPYDER REACTIVE DUELING TREE SHOOTING TARGET



With a few simple steps you will be able to set up and collapse your new Spartan Armor Systems® D.T. Spyder reactive dueling tree shooting target.

While setting up and collapsing the target system, please be careful to avoid finger or hand pinching hazards.

Set up and use the D.T. Spyder target system in a responsible manner and safe location.

TO COLLAPSE TARGET

- 1) Remove all 6 target paddles from target spine.
- 2) Pull up on the safety catch and pull target spine towards you. There is a safety catch for each of the two upper section of target spine.
- 3) Fold target spine down to its lowest upright position.
- 4) Lock spine in place with stabilizing foot. To do, this lift stabilizing foot up and at the same time slightly pull out target spine so that the safety latch is over the cross bar of the stabilizing foot
- 5) Pull up the stabilizing foot and aligning the curve that is cut out of the spine with the top curve of the stabilizing foot cross bar. Once aligned the stabilizing foot will snap into place and secure the spine.
- 6) Remove silver cotter pin (detent pin) from target base and target spine.
- 7) Fold down target spine to the ground and insert the cotter pin (detent pin) into the back hole of target stand bracket, through the holes in the spine and out through the other hole on the other side of the target stand bracket until the spring-loaded ball in the cotter pin (detent pin) locks the pin in place.
- 8) Starting with either back leg, pull up on the spring-loaded pull pin and swing the leg inward. Release the spring-loaded pull pin and continue to fold in the leg until the spring-loaded pin locks into place, securely holding leg in the folded-in position.
- 9) Repeat Step 8 for the other three legs.
- 10) Once the D.T. Spyder target is collapsed, load the shooting paddles in the paddle caddy on the rear legs (paddles face forward) and the D.T. Spyder shooting target is now ready for transport and storage.

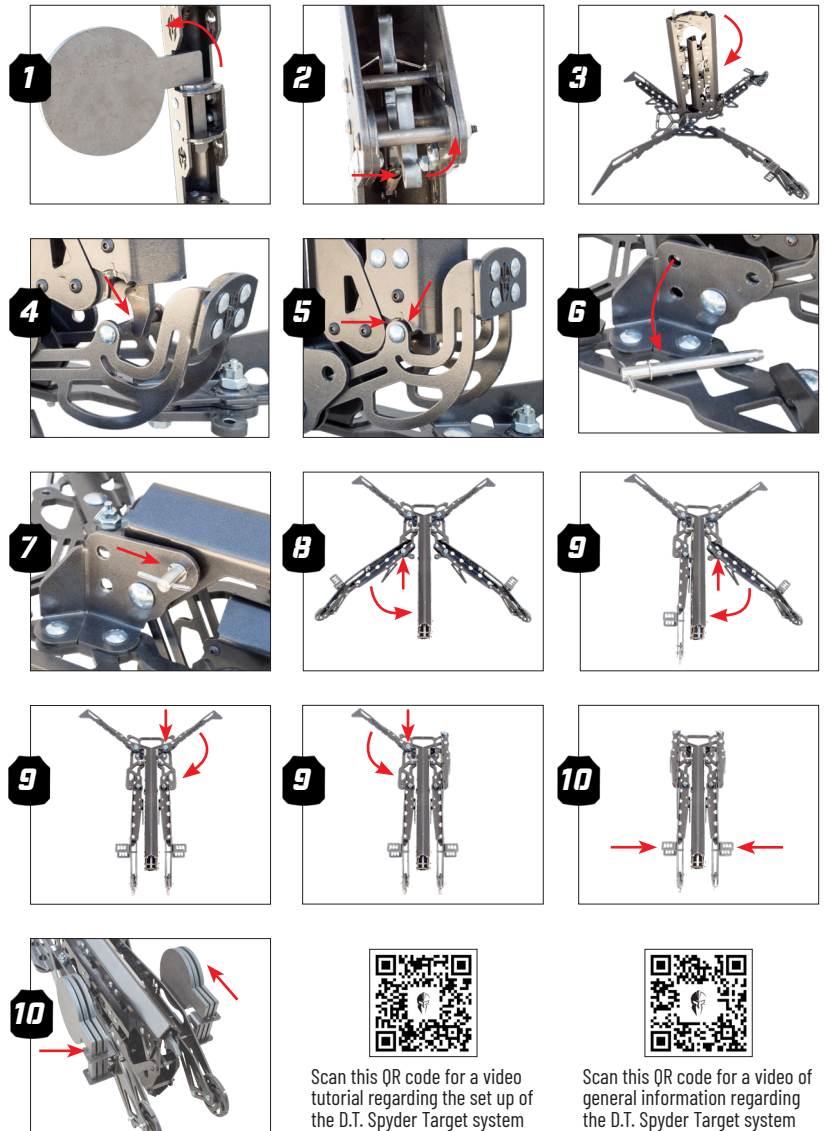

Scan this QR code for a video tutorial regarding the set up of the D.T. Spyder Target system



Scan this QR code for a video of general information regarding the D.T. Spyder Target system